

POCATELLO • CHUBBUCK  
IDAHO



# SPORTS FACILITIES & EVENTS GUIDE



[visitpocatello.com](http://visitpocatello.com)

What's Inside

# SPORTS LOCATIONS

- Mountain View Events Center .....3
- Portneuf Wellness Complex Soccer Fields .....5
- North Bannock Event Center .....7
- Idaho State University ICCU Dome (Holt Arena) .....8
- Cotant Park Baseball Fields.....9
- Capell Park Chubbuck.....10



# Welcome to

## The Pocatello & Chubbuck Area!

This guidebook will help you find some excellent options for Sporting events, Tradeshows, Expos, Concerts, Rodeos, large presentations and gatherings of any size.

Scan here



We are uniquely situated at the Eastern edge of the Snake River Plain where the high desert meets the Rocky Mountains. Our beautiful and convenient location (at the intersection of I-15 & I-86) allows us to offer a vast array of activities. Here you'll find most folks are friendly, helpful and possess a genuine western work ethic.



For more information about things to do, places to stay, and where to eat - go to [visitpocatello.com](http://visitpocatello.com)

Each page of this guide has a QR code that will take you directly to more info about each location.

We'll see you soon!

*Jeff Glissendorf*

Visit Pocatello | 208.425.1820



## MOUNTAIN VIEW EVENT CENTER

A Multipurpose Event and Sports Center in Pocatello, Idaho

- 40,000 sq. ft. multi purpose event center
- 28,000 sq. ft. open span gym area (178'6" x 158')
- 3 - full size basketball courts (84'x50')
- 6 - regulation size volleyball courts
- 10 - pickleball courts
- Bleacher seating for ~1,000
- Full PA System
- 50 - round tables (Accommodates 500 people)
- 50 - 6 ft tables • 500 - Chairs
- 2 - Projector screens
- Carpet cover to protect our hardwood floor
- Conference room with 18' table and seating for ~15
- 2 - Official rooms
- 2 - Locker rooms
- Medical room
- Full service concession area



Scan here  
for more information



1567 Way to Grace Avenue, Pocatello, ID 83201

**208.235.7659**



# PORTNEUF WELLNESS COMPLEX SOCCER-FIELDS

- 7 Full-Size Soccer Fields!
- Adjacent to a plethora of Amenities in Pocatello's New Outdoor Complex.



Scan here  
for downloadable  
maps, links, and more  
information



To Schedule Your Event Call  
**208.237.1340**



# NORTH BANNOCK EVENT CENTER

- Indoor Arena 240' x 120',  
Seats 500
- Covered Grandstands 250' x 190',  
Seat 3,500
- Overnight Haul-In Stalls  
Paystation on site
- Live Racing Quarter Horse &  
Thoroughbred in May
- State-of-the-Art Paddocks
- 4 Outdoor Riding Arenas
- Vendor, Concessions & Beer  
Garden Area
- 120 RV sites open year round with  
water, power and restrooms

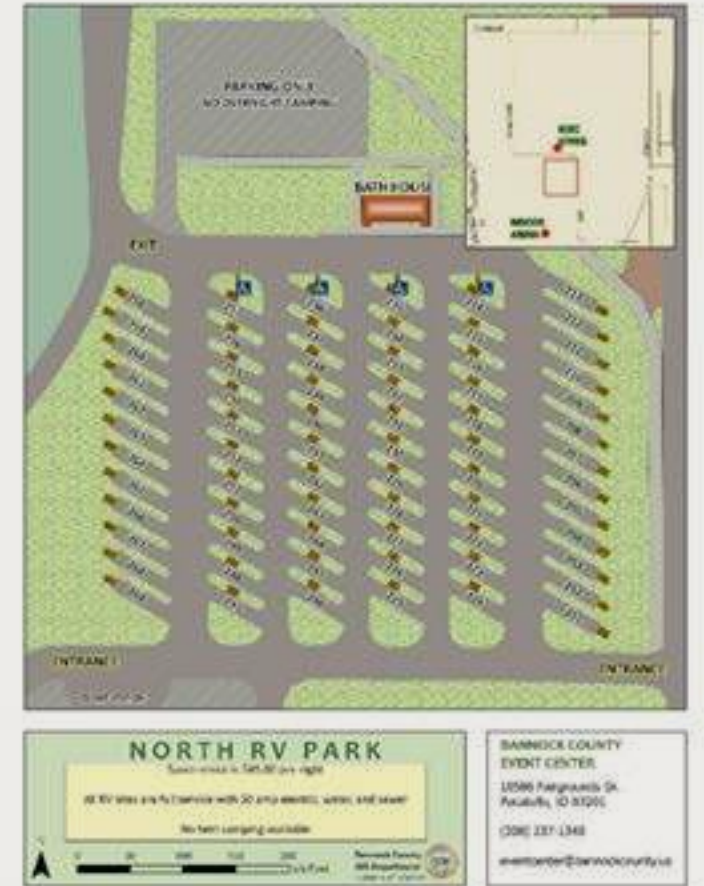

Scan here  
for downloadable  
maps, links, and more  
information



For Equestrian Enthusiasts and Rodeo Participants  
**208.237.1340**

# IDAHO STATE UNIVERSITY ICCU DOME (HOLT ARENA)

Holt Arena was the first covered college stadium in the nation.  
Renovated and renamed the ICCU Dome on January 9, 2024.



Scan here  
for more information



550 Memorial Drive, Pocatello, ID 83201  
**208.282.4931**

# COTANT PARK BASEBALL FIELDS

- 22.04 Acres
- Six Baseball Fields
- Two Basketball Courts (105'x60' and 50'x50')
- Four Tennis Courts
- Volleyball
- Bleachers
- Gazebo with Water and Power (To Reserve)
- Pavilion - 30'x20'
- Child Lot - 105'x65'
- Multiple Sheds
- Concession Stand & Restrooms



Scan here  
for more information



625 Victor Ave, Chubbuck ID 83202  
Contact Parks Manager Aaron Schilhabel

**208.237.2430 ext. 120 | [aschilhabel@cityofchubbuck.us](mailto:aschilhabel@cityofchubbuck.us)**

# CAPELL PARK CHUBBUCK

- 17.34 Acres
- Three Baseball fields (Softball Facility)
- Eight Tennis Courts
- Two Hockey Rinks
- Bleachers
- Hockey Equipment/Maintenance Building
- Multiple Sheds

Scan here  
for more information



5246 Park Lawn Dr, Chubbuck, ID 83202  
Contact Parks Manager Aaron Schilhabel  
**208.237.2430 ext. 120 | [aschilhabel@cityofchubbuck.us](mailto:aschilhabel@cityofchubbuck.us)**

What's Inside

## EVENT LOCATIONS

Idaho State University Alumni Center - ICCU Event Hall....	12
Purpose Center .....	13
Shoshone-Bannock Hotel & Event Center.....	14
Idaho State University Stephens Performing Arts Center .....	15
Portneuf Wellness Complex.....	17

# IDAHO STATE UNIVERSITY ALUMNI CENTER - ICCU EVENT HALL

- 1,000 max. capacity
- Large Half | 4,452 sq. ft. | 636 max. capacity
- Small Half | 2,548 sq. ft. | 264 max. capacity
- Atrium** | 110\* max. capacity. 1,705 sq. ft.  
(\*Depending on use of Event Hall)
- Boardroom** | 60 max. capacity. 900 sq. ft.
- Lounge** | 12 max. capacity. 352 sq. ft.



Scan here  
for more information



1601 E. Bonneville Street, Pocatello, ID 83201  
**208.282.3730**

# PURPOSE CENTER

Beautifully Restored Historic Building in  
Downtown Pocatello.

- 6,000 SQ. FT Event Venue
- 9,400 SQ. FT. Office Space
- 5,500 SQ.FT. Executive Suites
- 1,000 SQ.FT. Café
- ADA Compliant Elevator & Bathrooms
- Premium Teas, Coffee & Pastries



Scan here  
for more information



224 N. Main Street, Pocatello, Idaho 83204  
**208.681.6028**



# SHOSHONE-BANNOCK HOTEL & EVENT CENTER

- 13,823 square feet of flexible meeting space.
- 10 meeting rooms
- Banquet and convention services
- 156 guest rooms (11 suites)
- ADA-accessible rooms
- Spa Services
- Pool & Jacuzzi
- Fitness Center



Scan here  
for more information



I-15, Exit 80 in Fort Hall, Idaho, just 10 miles North of Pocatello  
**208.238.4800**

# IDAHO STATE UNIVERSITY STEPHENS PERFORMING ARTS CENTER

It crowns a Pocatello hilltop! This facility was ranked fourth in the nation as one of the top 25 most amazing performing art centers.

- 123,000-square-foot, state-of-the-art complex
- 1,200-seat grand concert hall
- 450-seat thrust stage theatre
- 200-seat black box theatre
- Rotunda
- Box office
- Practice rooms and shops



Scan here  
for more information



1002 Sam Nixon Drive, Pocatello, Idaho 83209  
**208.282.3595**

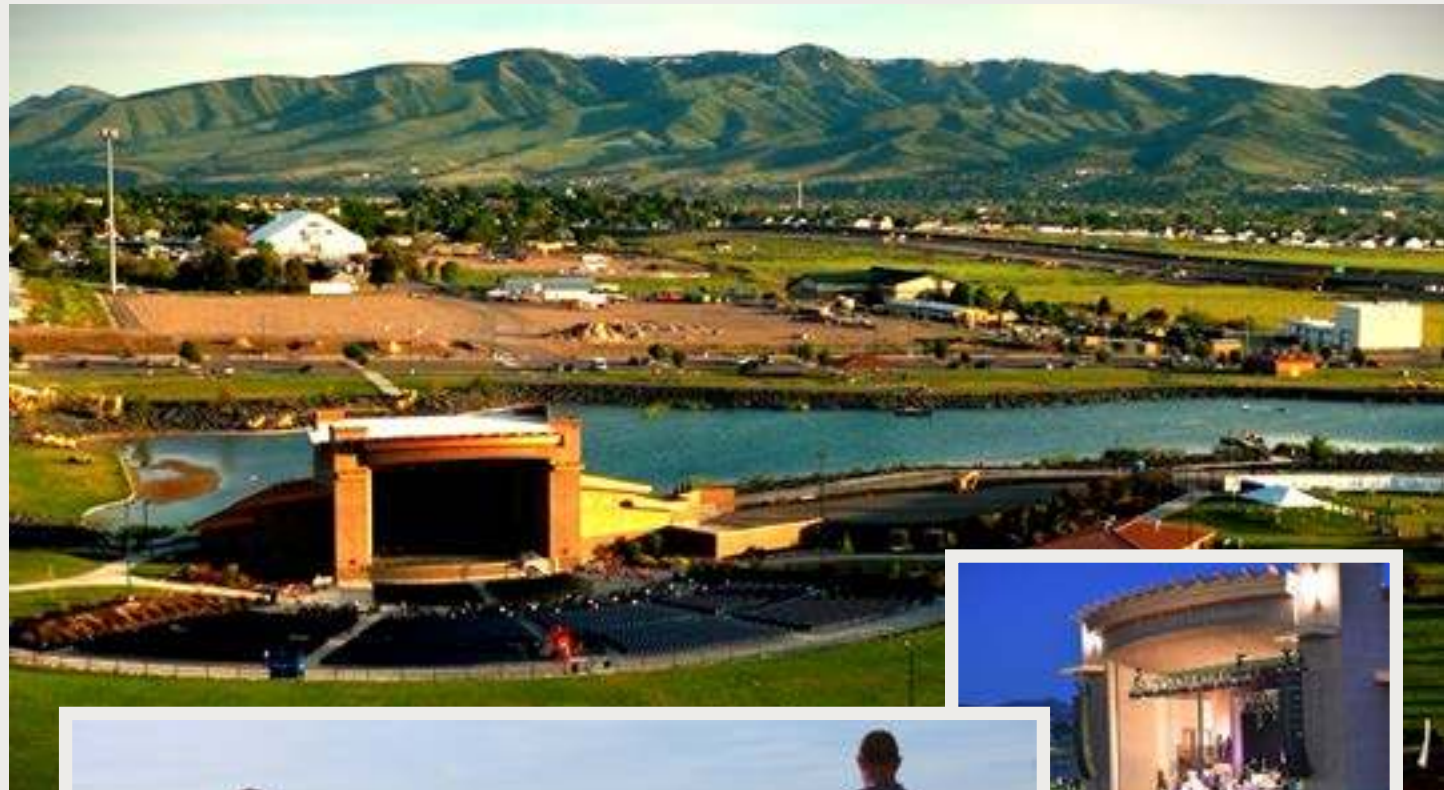

# PORTNEUF WELLNESS COMPLEX

A State-of-the-Art Amphitheater in the Center of Our New 80-Acre Complex!

- Amphitheater with seating for 11,000
- 6.5 Acre Lake with Swimming Beach & Fishing Docks
- Mountain Bike Park & Pump Track
- 7 - Full-Size Multi-Use Fields with One Isolated Championship Field
- 2 - Full Basketball Courts
- 4 - Tournament Sand Volleyball Courts
- 4 - 40' x 40' Pavilion
- Trail System Throughout



To Schedule Your Event Call  
**208.237.1340**

Scan here  
for downloadable  
maps, links, and more  
information





  
IDAHO  
visitidaho.org  
24-V-300